

MINOT SCHOOL DISTRICT CLASSROOMS

Mobile Modular created 65,000 square feet of educational space at three different locations after floods in Minot, ND.

THE CHALLENGE

After the flooding of the Souris River in Minot, North Dakota in June of 2011, the school district was concerned about how and where to begin the upcoming school year. The devastating flood that struck much of North Dakota displaced roughly 776 students when the Souris River spilled over protective levies and flooded schools, businesses, and thousands of homes.

The District, working cooperatively with FEMA, turned to Kraus Anderson Construction Company (KA) of Minneapolis, Minnesota to assist with flood recovery efforts, both temporary and long-term. KA selected Mobile Modular to provide temporary modular classroom buildings. KA acted as the construction manager and was responsible for the overall project management, including site preparation and utility work while our team delivered, installed, and finished the modular classroom buildings.

Contact Us Today!

866.889.7777 • mobilemodular.com

Customer Name: Minot School District

Project Location: Minot, ND

Building Type(s): Permanent Education Building

Job Type: Lease

Total Sq. Ft: 65,000 sq. ft.

THE SOLUTION

With an aggressive timeline for full project completion, KA and Mobile Modular responded to provide over 65,000 square feet of educational space, a total of 64 modular classrooms with restroom facilities, at three different sites. The buildings serve elementary school, middle school, adult learning, and Head Start students. The delivery and installation of the modular classroom complexes took place continuously throughout the month of August. By September 6, 2011, the district was once again able to welcome their students, only one week later than their normal start date.



BUILDING LAYOUT

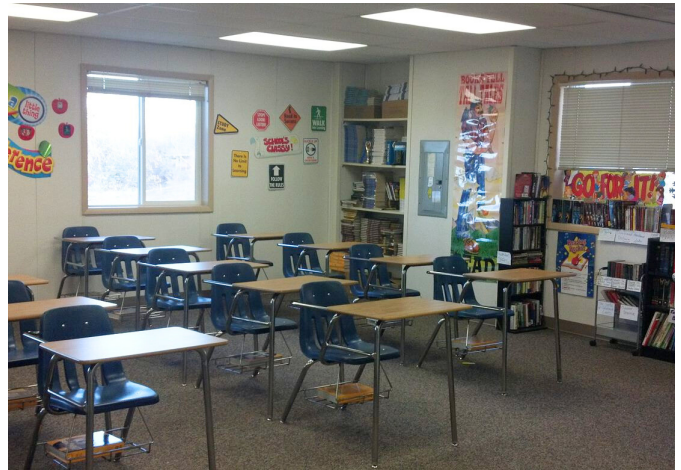
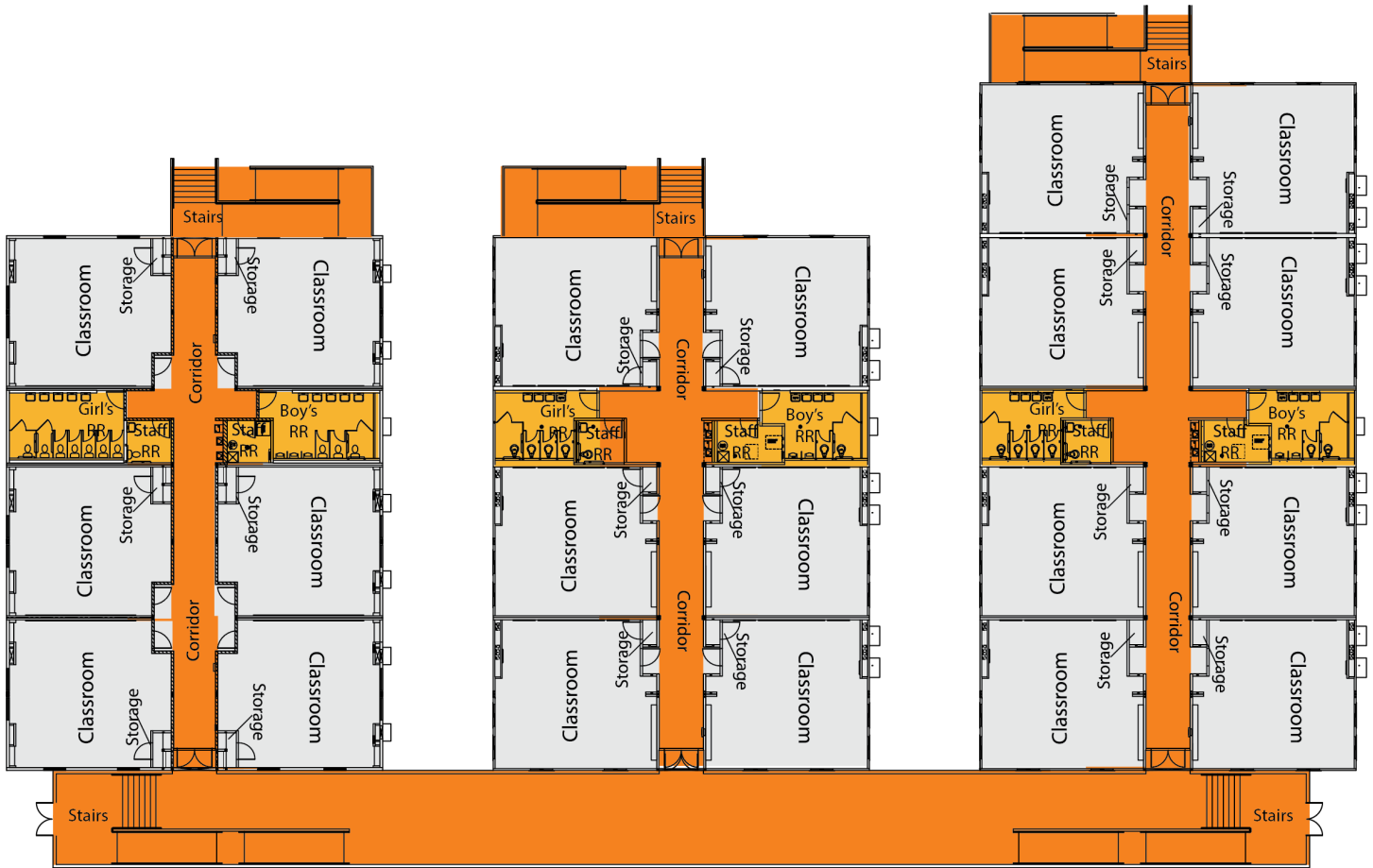

Contact Us Today!

866.889.7777 • mobilemodular.com

